

# Delany No. 50 Vacuum Breaker

## Genuine Renewal Parts

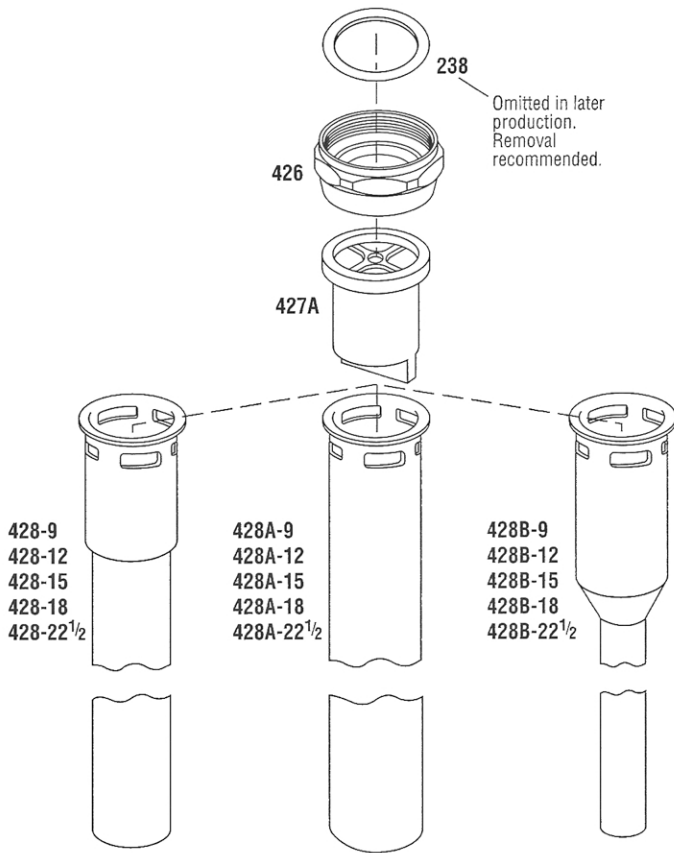

Individual Parts	
238	Coupling washer
426	Cowl nut
427A	Rubber sleeve with metal insert
428-9	Vented flush connection, 1 1/2" x 1 1/4" x 9"
428-12	Vented flush connection, 1 1/2" x 1 1/4" x 12"
428-15	Vented flush connection, 1 1/2" x 1 1/4" x 15"
428-18	Vented flush connection, 1 1/2" x 1 1/4" x 18"
★ 428-22 1/2	Vented flush connection, 1 1/2" x 1 1/4" x 22 1/2"
428A-9	Vented flush connection, 1 1/2" x 1 1/2" x 9"
■ 428A-12	Vented flush connection, 1 1/2" x 1 1/2" x 12"
■ 428A-15	Vented flush connection, 1 1/2" x 1 1/2" x 15"
■ 428A-18	Vented flush connection, 1 1/2" x 1 1/2" x 18"
† 428A-22 1/2	Vented flush connection, 1 1/2" x 1 1/2" x 22 1/2"
428B-9	Vented flush connection, 1 1/2" x 3/4" x 9"
428B-12	Vented flush connection, 1 1/2" x 3/4" x 12"
■ 428B-15	Vented flush connection, 1 1/2" x 3/4" x 15"
■ 428B-18	Vented flush connection, 1 1/2" x 3/4" x 18"
† 428B-22 1/2	Vented flush connection, 1 1/2" x 3/4" x 22 1/2"
430	Monel screen for vacuum breaker
431	Rubber sleeve with insert and Monel screen for use with stainless steel fixtures.

★ Not available in lengths greater than 22 1/2".

† For special lengths over 22 1/2", add suffix X and specify overall length.

■ Offsets available in 1/2" increments up to maximum of 3".

## Delany Flanges, Nuts and Flush Connectors

Coupling Nuts		
373A	3/4" x 3/4"	Coupling nut with No. 374 rubber washer (for Delany 472 valve only)
383A	1 1/4" x 1 1/4"	Coupling nut with No. 382P plastic washer
385A	1 1/2" x 1 1/4"	Coupling nut with No. 238 washer
388A	1 1/2" X 1 1/2"	Coupling nut with No. 238 washer
Spud Nuts		
375A	3/4"	Spud nut with No. 376 rubber washer
381A	1 1/4"	Spud nut with No. 382P plastic washer
386A	1 1/2"	Spud nut with No. 387P plastic washer
Spud Flanges		
302-1	3/4"	Spud flange, sure grip
307-1	1 1/4"	Spud flange, sure grip
306	1 1/2"	Spud flange
Wall Flanges		
300-1	1/2"	Wall flange, sure grip (slips 1/2" IPS)
301-1	3/4"	Wall flange, sure grip (slips 3/4" IPS)
308	3/4"	Cast wall flange with No. 341 allen head set screw (slips 3/4" IPS)
313	3/4"	Cast wall flange with No. 340 allen head set screw (slips covering tube for 3/4" sweat stop)
313S	3/4"	Wall flange, sure grip (slips covering tube for 3/4" sweat stop)
303-1	1"	Wall flange, sure grip (slips 1" IPS)
309	1"	Cast wall flange with No. 340 allen head set screw (slips 1" IPS)
314	1"	Cast wall flange with No. 340 allen head set screw (slips covering tube for 1" sweat stop)
314S	1"	Wall flange, sure grip (slips covering tube for 1" sweat stop)

Wall Flanges (continued)		
304-1	1 1/4"	Wall flange, sure grip (slips 1 1/4" IPS)
312		Cast wall flange to slip 1 1/2" tubing
Covering Tubes		
* 316		Covering tube 2" long (for 3/4" sweat stop)
* 315		Covering tube 4" long (for 1" sweat stop)
Flush Connections		
▲ 247	3/4" x 9"	Straight flush connection (for Delany 472 valve only)
▲ 248	3/4" x 9"	Straight flush connection, threaded one end
▲ 251	3/4" x 9"	Straight flush connection with cast collar
▲ 249	1 1/4" x 9"	Straight flush connection with flanged collar
▲ 250	1 1/2" x 9"	Straight flush connection with flanged collar
336A	1/14" x 5"	Flush elbow with one slip nut and washer
338A	1 1/2" x 5"	Flush elbow with one slip nut and washer
‡450A	3/4"	Flush elbow, scored one end, with one slip nut and washer (for concealed valve)
‡447A	1 1/4"	Flush elbow, scored one end, with one slip nut and washer (for concealed valve)
‡445A	1 1/2"	Flush elbow, scored one end, with one slip nut and washer (for concealed valve)

▲ Also available in lengths of 12", 15", 18" and 22 1/2". add \$1.80 to prices shown.

‡ For 1" wall thickness (actual length from centerline of elbow to end 4 3/4" for 3/4" elbow, 4 1/2" for 1 1/4" elbow, 4 5/8" for 1 1/2" elbow). to prices shown.

● Offsets available in 12", 15", 18" and 22 1/2" lengths only. Specify amount of offset in 1/2" increments up to maximum of 3"

\* For special length over 4", add suffix X and specify overall length.